

Standard Gain Horn Antenna WR-28/26.3-40GHz/15 dBi Typ, Gain

Model:TL-28SHA15

TL-28SHA15 is a standard gain horn antenna that operates from 26.3 GHz to 40 GHz. The antenna offers 15 dBi nominal gain. The input of this antenna is a WR28 waveguide with FBP320 anti-cocking flange. The standard gain horn is offered for antenna range calibration purpose mainly, but it can be also used for general purpose system set ups.

Features:

- Operating Frequency 26.3 to 40 GHz
- Linear Polarization
- Good Impedance Match

Applications:

- Antenna Ranges
- Antenna Gain Measurements
- System Setups



电气特性 Electrical Characteristics:

参数 Parameter	Min	Typ	Max	单位 Units
频率范围 Frequency Range	26.3		40	GHz
增益 Gain		15		dBi
驻波 Input VSWR			1.25	:1

环境和机械特性 Environmental And Physical Characteristics:

类型 Description	参数 Parameter	单位 Units
材质 Material	Cpper	
表面处理 Finish	Silver plated, Spray sea grey paint	
接口 Connectors	WR-28(Connector is customizable)	
尺寸 Size	26*19*35	mm

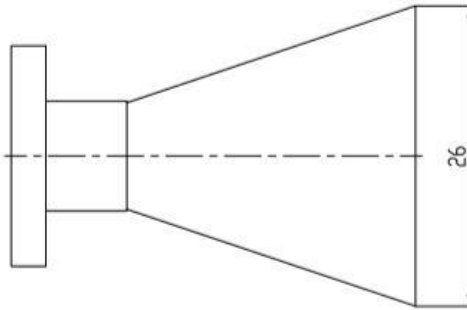
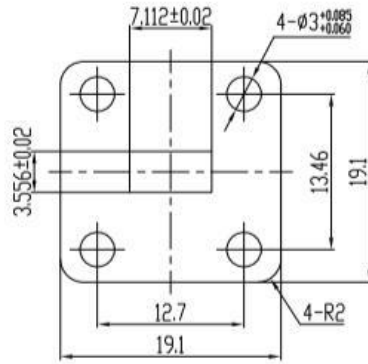
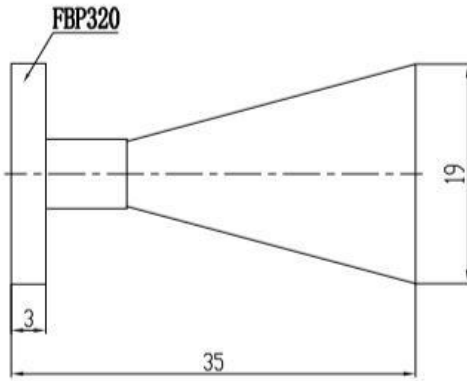
外形图 Outline Drawing: Unit:mm

ESD Protection: Strictly adhere to ESD precautions to prevent electrostatic damage.

订货信息 Ordering Information:

标准型号 Base Number	描述 Description	版本号 Revision
TL-28SHA15	Standard Gain Horn Antenna, 26.3-40GHz, Gain: 15 dBi Typ.	Rev.1.0

典型曲线 Typical Performance Data:

VSWR vs Frequency

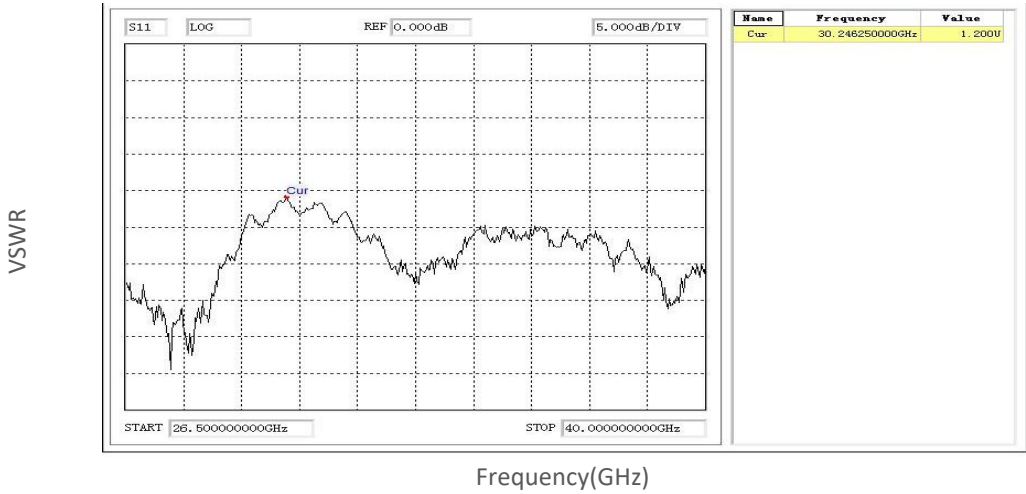

Gain vs Frequency

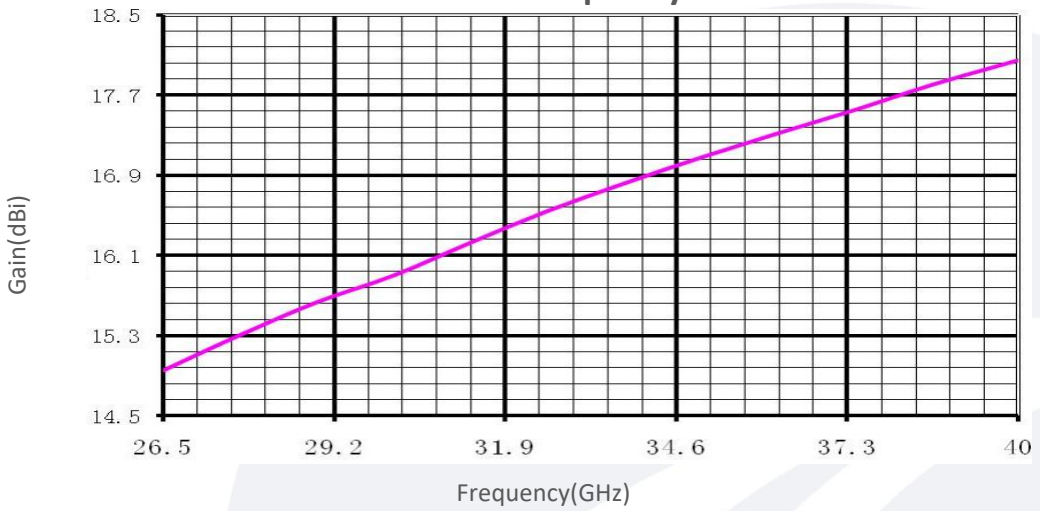

26.3GHz:

Amplitude vs Theta

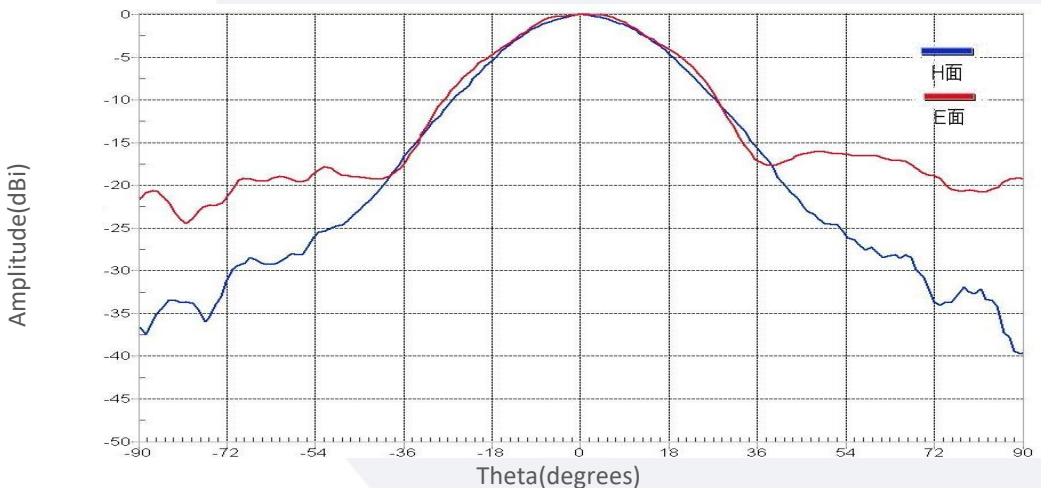

Note: Above data is for ref only, actual data may vary from unit to unit depending on operating environment and other factors like material lots etc.

典型曲线 Typical Performance Data:

33.15GHz:

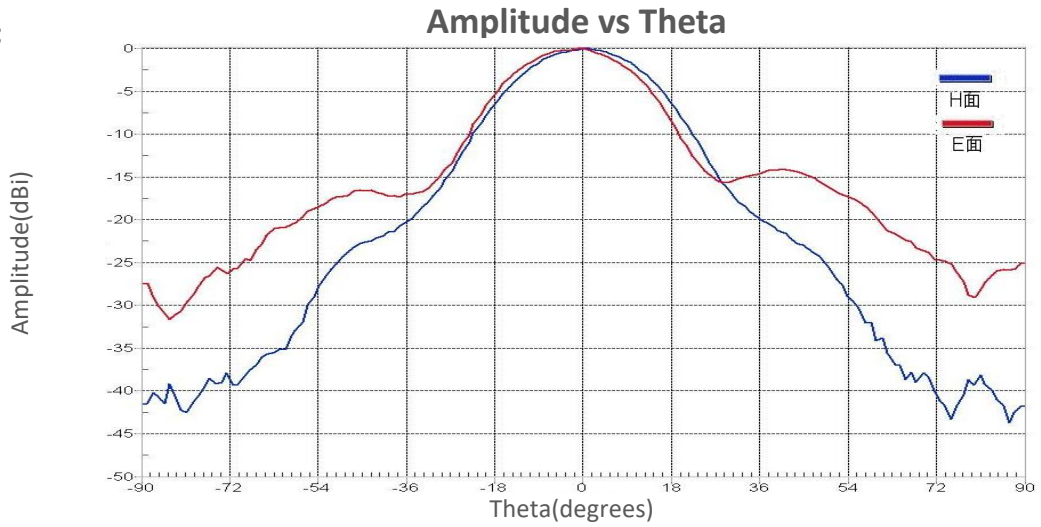

40GHz:

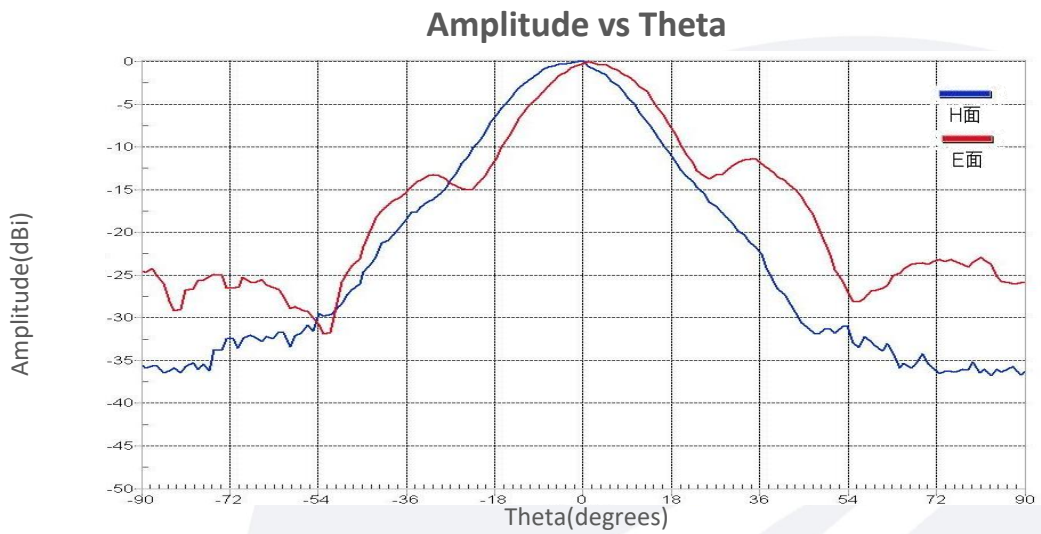

Note: Above data is for ref only, actual data may vary from unit to unit depending on operating environment and other factors like material lots etc.