

## Coaxial Termination

### DC-18GHz/SMA Female/2W

**Model:TT2-18-SMA-E-F**

The TT2-18-SMA-E-F is a well-matched, 50Ω Female termination enabling operation from DC to 18 GHz. This termination features a 2W power rating and 1.3:1 max VSWR.

#### Features:

- Operating Frequency DC to 18 GHz
- High Return Loss
- Instrumentation Grade

#### Applications:

- laboratory test
- Communication equipment

#### Electrical Characteristics:

Parameter	Min	Typ	Max	Units
Frequency Range	DC		18	GHz
VSWR			1.3	:1
Power Handling		2		W
Impedance		50		Ohms

#### Environmental And Physical Characteristics:

Description	Parameter	Units
Operating Temperature	-55 To +125	°C
Storage Temperature	-55 To +125	°C
Connector Material	Stainless steel	
Inner Conductor	Gold plated brass	
Connectors	SMA Female	
Size	ø7.45*17.8	mm

**Outline Drawing:**

Unit:mm

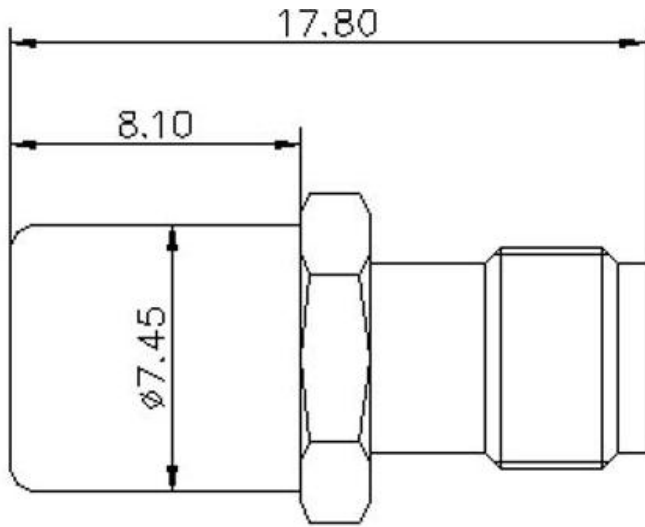

**Ordering Information:**

Base Number	Description
TT2-18-SMA-E-F	DC-18GHz,2W,SMA Female Coaxial Termination